



SUMMIT
w i r e l e s s

Summit Wireless Technology
"Superior Surround Made Simple"

MyZone™ Technology: ***Home Theater Surround Calibration*** ***with a Press of a Button***

Focus Enhancements, Inc.

September 1st, 2009

This paper describes the features and benefits of the MyZone technology included in Focus Enhancement's Summit Technology.

Disclaimer

The information contained in this document is the proprietary and exclusive property of Focus Enhancements, Inc. except as otherwise indicated. No part of this document, in whole or in part, may be reproduced, stored, transmitted, or used for design purposes without the prior written permission of Focus Enhancements, Inc.

The information contained in this document is subject to change without notice.

The information in this document is provided for informational purposes only. Focus Enhancements, Inc. specifically disclaims all warranties, express or limited, including, but not limited, to the implied warranties of merchantability and fitness for a particular purpose.

Table of Contents

Overview	4
Technical Challenge.....	5
FS848 MyZone™ Solution	6
FS848 MyZone™ Solution	7
Summary.....	10
Contact Us	11

Overview

Summit Wireless Technology is a premium wireless audio solution designed specifically for Home Theater audio applications. Summit was designed to solve Home Theater audio setup and distribution difficulties by delivering innovative features and capabilities in three key areas:

- **High Quality Audio**: Extracts the highest audio fidelity possible from the speaker drivers and cabinets through programmable filters and crossovers tuneable to each speaker's characteristics.
- **Ease of Setup**: Simplifies Home Theater audio setup and programming of audio sweet spot location to one button press.
- **Robust wireless network**: Provides a noise free, interference resistant, wireless network between the master and up to eight speakers, with 2 ms latency.

This White paper focuses on the MyZone technology, provided by Summit, which is one of several features enabled by Focus Enhancements that greatly simplify the Setup process of a Home Theater System.

This whitepaper builds on the SpeakerFinder™ technology described in a separate whitepaper. It is recommended that the reader read the SpeakerFinder whitepaper prior to reading this document. Please see the complete set of White papers on the FS848 HD Wireless Audio IC solution.

Technical Challenge

One challenge faced by Home Theater consumers once they've installed and wired their speakers, is the calibration of each of speakers channels for volume and phase delay for the desired listening location. The volume adjustment is crucial for ensuring that the volume level from each speaker is the same at the listener's position. The phase delay is critical to ensure that the sound from each speaker arrives to listening position at the desired precise moment. For instance if the surround speakers are 15 feet further away from the listener than the front speakers, approximately 13 ms of delay should be added to the front speakers.

With "Value" class Home Theater systems, surround calibration might not even be possible, or might be simply limited to setting the relative volume of each speaker by ear or with an aftermarket sound meter. Obviously this is a very rudimentary and cumbersome calibration at best.

With "Mid-range" Home Theater systems a microphone is sometimes included to automatically calibrate the volume level of each speaker in a calibration mode. This calibration technique typically requires placing the microphone in one or more positions throughout the room. The volume calibration method is moderately accurate (within 2 to 3 feet), although time consuming, noisy, and inconvenient. A few systems also support the ability to program the delay from each speaker such that sound arrives at the listening position at the same time. The calibration typically requires accurate measurement of distance from the listening location to each speaker. The delay for each speaker is then calculated by hand to by an algebraic formula and entered into the Home Theater system via the remote or the front panel. Obviously this is a complicated, time consuming process for the majority of consumers.

With “Hi-end” Home Theater systems, volume calibration with a wired, hand held microphone used at multiple locations within the room is typically standard. The most advanced systems also automatically calibrate the delay for each speaker such that the sound from each speaker arrives at the listening location simultaneously. Each time the user wishes to move the listening position, the lengthy calibration process must be repeated. These systems are often made for the custom installation market, requiring visits by an installation professional and the use of custom, expensive gear.

Summit MyZone™ Solution

The Summit MyZone functionality builds on top of SpeakerFinder™ to incorporate the listener's actual position in the room mapping process. With SpeakerFinder, the listener's position is assumed to be in the center of the surround speaker network based on a mathematical formula of the speaker positions located by ultrasonic transducers in each speaker.

With MyZone, an additional ultrasonic transducer is added to the system remote control. The listener initiates the MyZone calibration by holding the remote control at ear height and pushing the MyZone button at the desired listening location. The ultrasonic transducer in the remote "chirps", and all of the transducers in the speaker network listen and report back to the master the exact time they heard the chirp. The master uses this data to calculate the listener's position in X,Y space relative to the center speaker to within +/-1 in. (2.54 cm). The listener's actual position is then stored and updates the previously stored location in the room mapping equation. The system is auto-calibrated to the MyZone location upon each subsequent power up until a new MyZone location is set.



Figure 1: Ultrasonic Transducer

If a speaker is subsequently moved after setting MyZone, the volume and phase for the speaker network is again automatically recalibrated to center the sweetspot on the programmed MyZone location.

The coordinates of the MyZone location are used to calibrate the correct audio delay for each speaker in the room such that the sound from each speaker arrives simultaneously at the listener's MyZone location. This is accomplished by the Master instructing each slave module to delay the audio the correct amount. The amount of delay is very precise and is definable down to individual samples.

Alternatively, in higher end Audio Video Receivers (AVRs), which include sophisticated audio decoders, the speaker location information can be sent from the Summit system to the audio decoder DSP to provide the volume and delay adjustments based on its own algorithms.

Summit is capable of adding up to 40 ms delay for each speaker, which is sufficient to compensate for a 30 ft x 30 ft (9 m x 9 m) space. This delay capability is more than sufficient to support even the worst case scenario of a listening position being placed next to a speaker in the corner of a 30 ft x 30 ft (9 m x 9 m) room.

Unlike competing systems, the entire calibration process is silent, takes less than few seconds, does not require the use of a microphone, and is a very simple and intuitive process to the listener.

The MyZone feature enables a listener the convenience of setting the sweet spot for his/her favorite recliner to listen to classical music, and then later resetting it instantly to the sofa for family movie night.

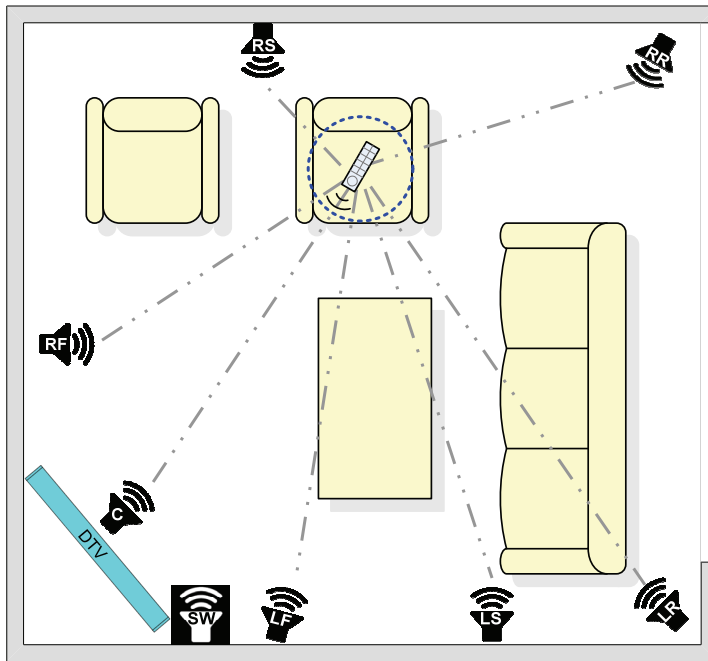

Figure 2: MyZone Mapped to Recliner

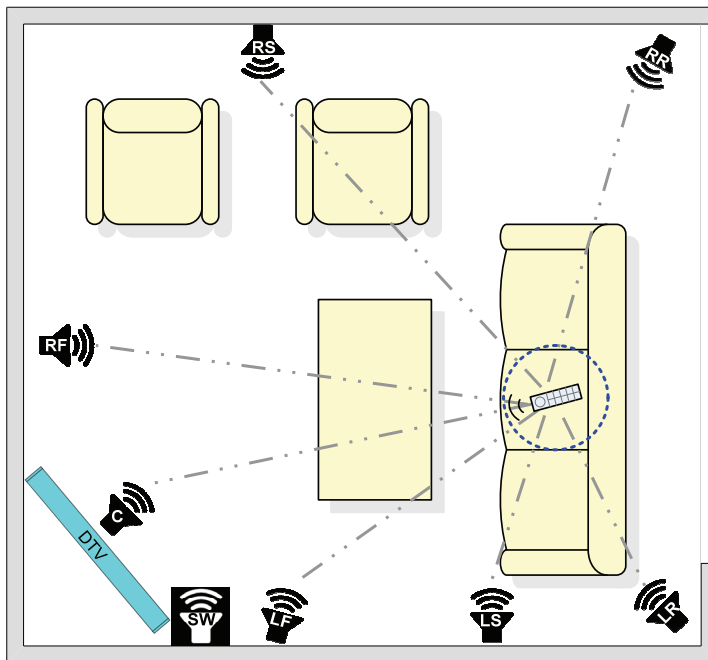

Figure 3: MyZone Mapped to Sofa

Summary

Summit wireless technology is a premium audio solution designed for Home Theater Audio systems to enable an auditory experience exceeding that of comparable wired systems, as well as set a new standard for “ease-of-use” in Home Theater audio.

MyZone is an innovative new technology that enables listeners to instantly and effortlessly calibrate their surround sound sweet spot, with accuracy, and simplicity never before possible.

The MyZone capability is only available on systems based on Focus Enhancement’s Summit wireless technology. The feature can be easily added at little additional cost or system complexity to product line based on the FS848. This enables an OEM to easily develop and market a family of products from single platform architecture with different features sets and price points.

Summit Wireless Technology
“Superior Surround Made Simple”

Contact Us

Focus Enhancements, Inc – Semiconductor Division

Address: 22867 NW Bennett Street, Suite 200

Hillsboro, Oregon

97124

USA

Email: info@focussemi.com

Website: www.summitwireless.com

Tel: 503-615-7700

Fax: 503-615-4232

Copyright ©2009 Focus Enhancements, Inc. All Rights Reserved.

Focus Enhancement, and Summit Wireless logos and trademarks are registered trademarks of Focus Enhancements or its subsidiaries in the United States and other countries.

Copyright ©2009 Focus Enhancements. All Rights Reserved.

Other names and brands may be claimed as the property of others. Information regarding third party products is provided solely for educational purposes. Focus Enhancements is not responsible for the performance or support of third party products and does not make any representations or warranties whatsoever regarding quality, reliability, functionality, or compatibility of these devices or products.